



HEATHROW BOULEVARD 4 CURRENT AVAILABILITY FLOOR PLANS

SECOND FLOOR

SUITE 1: 1,205 SQ FT (112 SQ M)

SUITE 5: 3,500 SQ FT (325 SQ M)

ALL AREAS ARE MEASURED IN ACCORDANCE WITH IPMS3

■ AVAILABLE ■ OCCUPIED

PARKING SPACES

SUITE 1 - 3 SPACES

SUITE 3 - 10 SPACES

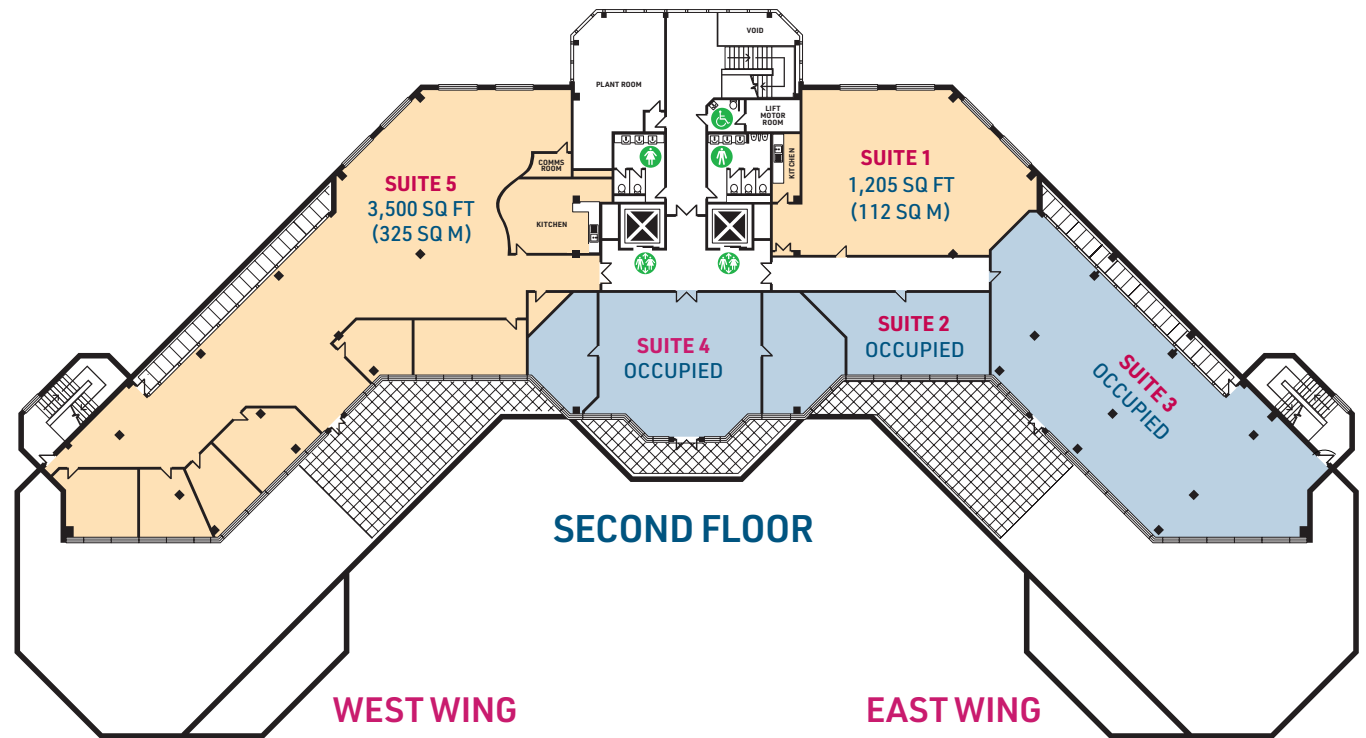

"Firstco have based our Airport Engineering Team at Heathrow Boulevard. This places us close to one of our key clients and offers flexible office space within a well-maintained business park. This is our second office with Orbit Southern and we look forward to continuing the relationship further in the future."

Steve Ikin, Associate Director, Firstco Ltd



HEATHROW BOULEVARD 4

CURRENT AVAILABILITY

FIRST FLOOR

SUITE 1: 1,115 SQ FT (104 SQ M)

SUITE 2: 1,420 SQ FT (132 SQ M)

■ AVAILABLE ■ OCCUPIED

PARKING SPACES

SUITE 1 - 3 SPACES

SUITE 2 - 4 SPACES



* Available on a managed office agreement or a standard commercial lease

"We have rented office space at Heathrow Boulevard for over 5 years now and have developed a great working relationship with Orbit Southern. The proximity to the Airport allows us easy access to our project sites there and to be close by to our customers, which is vital for our business. It is also very convenient for our staff who regularly travel on business."

Joanne Hughes, Executive Assistant & Office Manager, Beumer Group UK Ltd



HEATHROW BOULEVARD 4 CURRENT AVAILABILITY FLOOR PLANS

GROUND FLOOR

SUITE 2B: 858 SQ FT (80 SQ M)

SUITE 3A: 872 SQ FT (81 SQ M)

SUITE 5: 6,540 SQ FT (608 SQ M)

■ AVAILABLE ■ OCCUPIED

PARKING SPACES

SUITE 2B - 3 SPACES

SUITE 3A - 2 SPACES

SUITE 5 - 18 SPACES

* Available on a managed office agreement or a standard commercial lease

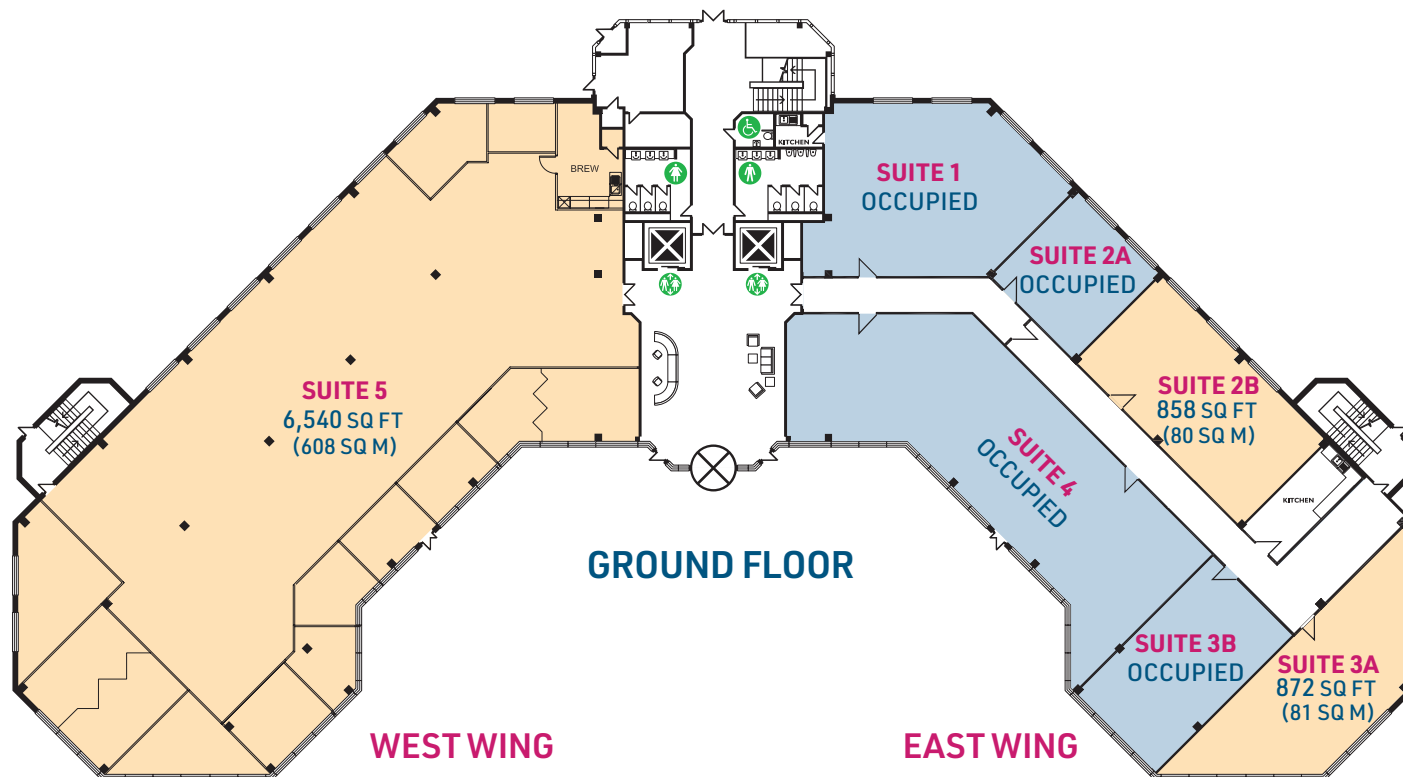

"Firstco have based our Airport Engineering Team at Heathrow Boulevard. This places us close to one of our key clients and offers flexible office space within a well-maintained business park. This is our second office with Orbit Southern and we look forward to continuing the relationship further in the future."

Steve Ikin, Associate Director, Firstco Ltd